



OPERATORY CABINETS

ARTIZAN® EXPRESSIONS
SYNTHESIS® CASEWORK COLLECTION



CABINETS THAT FITS EXACTLY WHO YOU ARE

Your operatory cabinetry plays a critical role in your practice. It *reflects* who you are as a professional and *affects* how your practice operates. To help you get the most of out of your practice—both the look and feel of the physical space in addition to the interaction between you and your patients—Midmark provides innovative solutions in dental cabinetry that fit the feel and flow of your specific practice.



06

IDEA STARTERS

Operatory designs to help you get started thinking about how you want to work and what is really most important to you.



22

THINGS TO CONSIDER

There are many things to think about when designing your operatories. We'll get you started with thought-provoking questions to step you through the process.



24

MIDMARK CABINETS VS. LOCAL MILLWORK

Dental manufactured cabinetry is an important investment. Understand why it is more than worth it.



26

UNDERSTANDING THE DETAILS

Midmark offers two different lines of cabinetry. While both are designed to support proper operatory function, each have unique looks and solutions for creating your ideal space.



36

WHAT YOU GET WITH MIDMARK

We don't want to just meet your expectations, we want to exceed them. See how you will benefit when you partner with Midmark.



40

RESOURCES

Our design tool and videos will put your mind at ease when making important decisions about your operatories.

LEADING THE WAY IN PATIENT CARE

Since the moment Midmark entered the dental industry, helping advance patient care has been our passion. Today, our number one commitment is offering you dental cabinetry and workflow solutions that allow you to focus on what you do best—care for your patients.

Because dental practices are specialized treatment facilities, you have unique requirements that go beyond the capabilities of average millwork. Midmark's technology and equipment are designed to help ensure a safe and efficient environment that fosters the caregiver-patient interaction and is conducive to the delivery of high quality care.



EVERY MINUTE COUNTS

You pride yourself for being on the cutting edge of dentistry. The right investment in technology and equipment can help you make the most of your time and achieve better patient care and overall satisfaction.

PRODUCT

Cabinetry: Synthesis® treatment station, central station, side cabinet, dispenser and upper storage | **Chair:** Elevance® **Unit:** Elevance® left-right doctor's delivery and rear cabinet-mounted assistant's delivery | **Light:** Cabinet-mounted LED | **Stools:** Doctor and assistant's stool | **X-ray:** Preva mounted in central station **Monitor:** left-right monitor mount

COLORS

Cabinet: Acorn | **Countertops:** Aria Viatera® Quartz
Upholstery: Charcoal Ultraleather® | **Wall:** Argos SW7065
Floor: Mannington Adura Vibe



Investments in technology can help drive better clinical results, increase patient satisfaction, and increase your return on investment.

HIGHER TECH. HIGHER EFFICIENCY.

Technology is your focus. But it's only half the story. Streamlining processes and operatory efficiency are vital. Thoughtful design is integrated into all Midmark equipment to keep your office running as efficiently as possible.

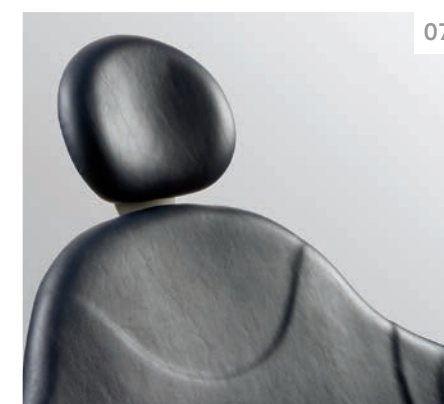
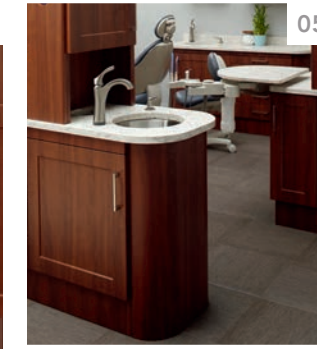
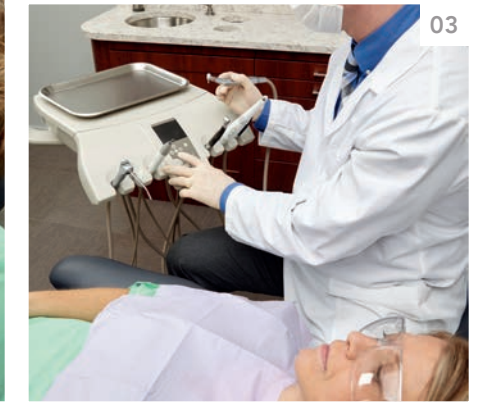

SOLUTIONS THAT HELP YOU BE MORE EFFICIENT

- 01| Patient-Facing Monitor** allows treatment options to be easily reviewed and discussed.
- 02| USB Options** allow you to charge ancillary devices and transport data.
- 03| Integration Control Module®** manages all of your delivery components from one location, giving you maximum control that is simple to operate.
- 04| Upper Tower Storage** frees up lower cabinet for supplies while housing CPU with built-in venting and cable management.
- 05| Central Station Efficiencies** allow you to share one x-ray between two rooms and one sink between two operatory entries.
- 06| Equipment Drawers** bring items like lasers and other small equipment closer to you, promoting better ergonomics and efficiency.
- 07| Limited Seam Upholstery** makes cleaning chairs easier and operatory turnover quicker.

PATIENT FOCUSED

In your practice, the comfort of every patient matters. And nothing builds trust better than a warm and inviting setting. Midmark transforms the cold and clinical equipment of the past into a vibrant symbol of your passion.

PRODUCT

Cabinetry: Artizan® Expressions treatment station, central station, side cabinet | **Chair:** Elevance® with Serenescape®
Unit: Rear cabinet-mounted Procenter doctor's delivery and assistant's delivery | **Light and Monitor:** LED Track Light Monitor | **Stools:** Doctor and assistant's stool | **X-ray:** Preva mounted in central station

COLORS

Cabinet: Black Riftwood (bottom), Pewter Frost (top)
Resin: Silver Spun Lumicor® | **Countertops:** Minuet Viatera® Quartz
Upholstery: Sorbet Ultra leather® | **Wall:** Argos SW7065
Floor: Shaw - Thoroughly Modern 6; color: Debutante



Is it furniture or art? Actually, it's both. Our cabinetry achieves the ideal balance between expressive design and operational efficiency.



EXPRESSIVE DESIGN AND FUNCTION

You already know that your patients' comfort and satisfaction are affected by the look and feel of the space around them. Create a warm and inviting operatory that is functional and durable enough to withstand the rigors of the dental environment.

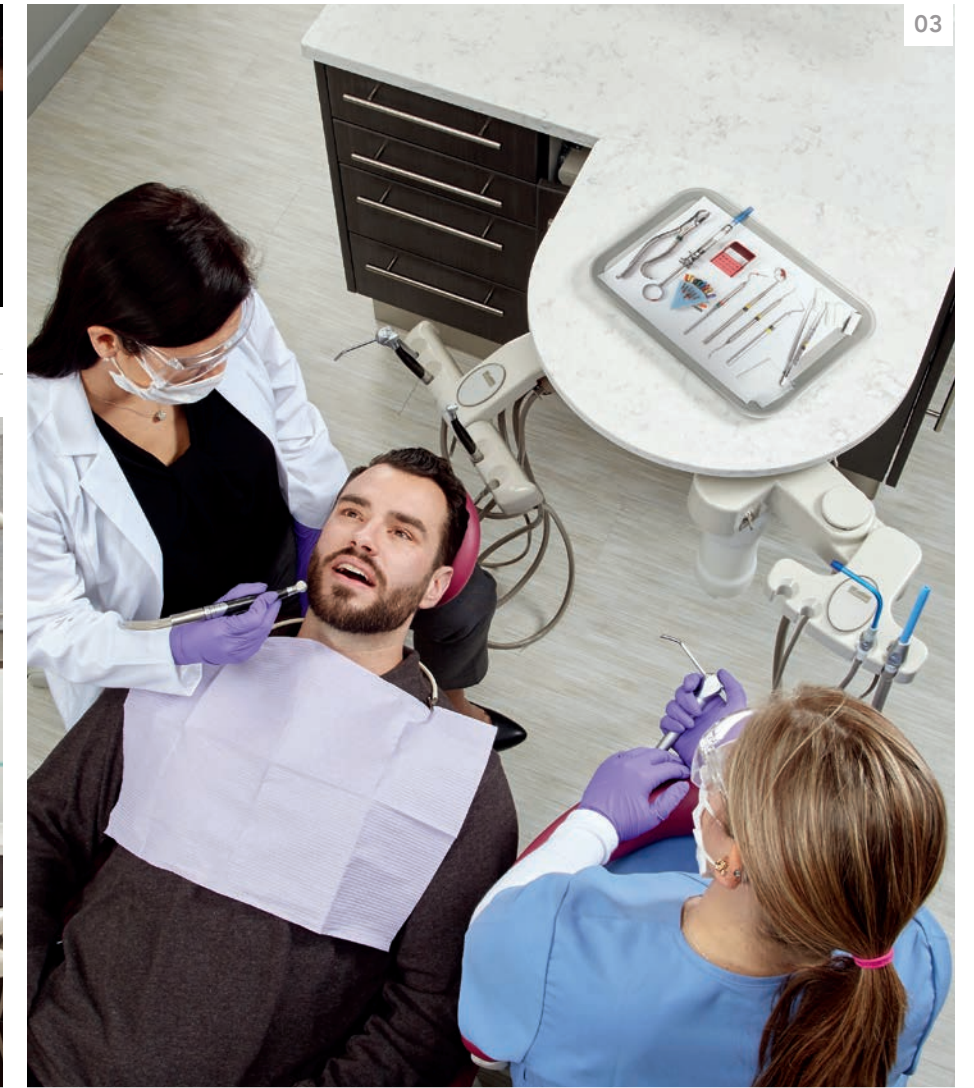
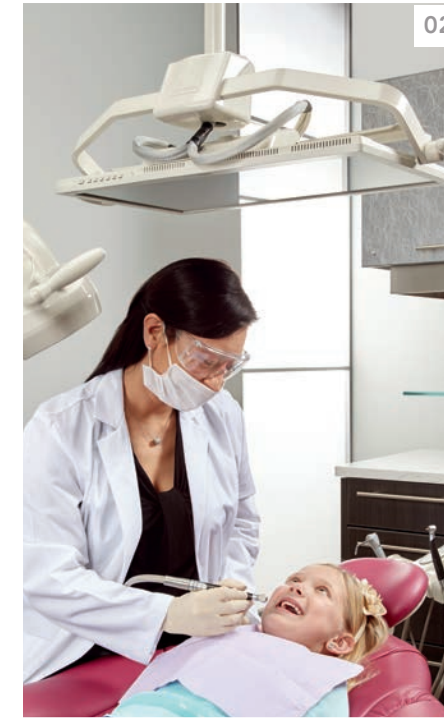

SOLUTIONS THAT PUT YOUR PATIENTS AT EASE

01| Attractive Cabinetry creates an inviting environment that reflects the quality of care you provide.

02| Track Light Monitor enhances patient experience by providing entertainment during procedures and education for better case acceptance.

03| Rear Delivery reduces patient anxiety by keeping tools out of view.

04| Two-Tone Color on the same cabinet can make a space feel lighter and more open.

05| Chair Heat and Massage keeps patients warm and relaxed during long procedures.

06| Unique Storage Options allow clinical supplies to be hidden from patients yet easily accessible by staff.

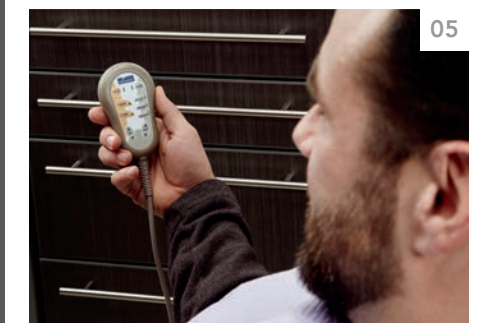

SMALL SPACES BIG IDEAS

Are your ambitions larger than your floor plan? We've got you covered. Our custom and modular cabinetry and operatory equipment are designed for maximum efficiency in minimal spaces.

PRODUCT

Cabinetry: Artizan® Expressions expanded treatment station, side station, and wall storage module | **Chair:** UltraTrim®
Unit: Procenter side delivery and rear cabinet-mounted assistant's delivery | **Light:** Ceiling mounted LED | **Stools:** Doctor and assistant's stool | **Monitor:** Sliding track monitor mount on treatment station

COLORS

Cabinet: Walnut Riftwood | **Resin:** Meadow Lumicor®
Countertops: Granola Corian® Solid Surface | **Upholstery:** Lake Ultraleather® | **Wall:** Olympus White SW6253 | **Floor:** Shaw Boulevard; color: Crisp Linen



With clever storage solutions and custom-built components, Midmark cabinetry fits around your space and your ideal workflow.

WORK WITHOUT LIMITATIONS

Small nooks and snug spaces make for cozy and intimate settings, but also present unique workflow challenges. For those hard-to-fit places, Midmark equipment is designed to open up the possibilities of your office with clever cabinetry and smart workflow solutions.

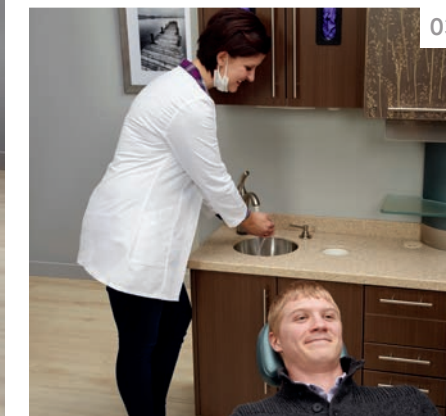

SOLUTIONS THAT MAKE THE MOST OF YOUR LIMITED SPACE

- 01| **Chair Rotation** allows better access to the patient in small spaces.
- 02| **Side Delivery** docks out of the way when not in use, opening space for other carts or equipment to be brought in and out.
- 03| **Shallow Expanded Treatment Stations** have a small footprint and can provide a sink with additional storage at the operatory entry.
- 04| **Slide-Out Storage** can be prepped with commonly needed supplies keeping staff from leaving the operatory and making the supplies easily accessible during procedures.
- 05| **Lift-Up Doors** provide greater clearance in tight spaces and allow visibility to all upper contents upon opening.

BIG TEAM PRACTICE

Your practice is large, polished, and successful. But even in the face of impressive growth, the bottom line still matters. Striking the right balance between attractive cabinetry and equipment and long-lasting value is important.

PRODUCT

Cabinetry: Synthesis® upper storage units and base treatment station, Artizan® Expressions: Wall-hung side cabinets, dispenser and x-ray pass through cabinet | **Chair:** UltraTrim® | **Unit:** Asepsis® 21 left-right doctor's delivery and left-right rear chair-mounted assistant's delivery
Light: Left-right halogen | **Stools:** Doctor and assistant's stool
X-ray: Preva pass-through mounted

COLORS

Cabinet: Synthesis®: Henna; Artizan® Expressions: Smoked Knotty Ash
Countertops: Hazelnut Corian® Solid Surface | **Upholstery:** Sonora Ultraleather® | **Wall:** Colonial Revival Gray SW2832 | **Floor:** Shaw Renaissance; color: graphite



Get the most out of your investment. Midmark's flexible cabinetry lets you mix and match from either of our cabinetry lines for a seamless blend of form and functionality with long-lasting value.



GREATER VOLUME. GREATER VALUE.

Midmark durability and quality work as hard as you do, even in the most heavily trafficked areas of your practice. With modular designs, equipment compatibility and innovative design solutions, Midmark makes it possible to provide exceptional care for an exceptional value.



SOLUTIONS THAT HELP YOU GET THE MOST OUT OF YOUR INVESTMENT

- 01| **Modular Cabinets** can provide needed storage, function and additional value.
- 02| **Wall-Hung Side Cabinets** provide storage and secondary work surface support and can easily be cleaned under for high traffic areas.
- 03| **Left-Right Equipment Compatibility** allows multiple operators to use the same operatories without compromising functionality.
- 04| **Wall Pass Pass-Through Cabinets** are a cost effective way to share x-rays between two operatories.
- 05| **Special Packages** offer quality and reliability with an affordable chair, unit and light bundle.

THINGS TO CONSIDER

What's important to you? We're not just asking about cabinet colors and options, but also how do you want to practice? It's a good idea to begin thinking about what you want and need in your operatories to be effective and make the delivery of care more efficient. Based on years of observing the clinical space, we have one basic recommendation: Design not just for how your operatories will look, but how you want to work in them and the environment you want to create.

FIRST THINGS FIRST

Grab a pen and answer these initial questions:

1. What do you like about your current operatory design?

2. What aspects of your current operatory design do not allow you to deliver quality care?

3. What do you want your operatory design to be able to do that you cannot today?

4. What image do you want your future operatory design to portray to your patients?

With 1 being the highest and 7 being the lowest, rank in order the importance of the following when considering your future operatory design.

Durability & Longevity
 Design Flexibility
 Patient Comfort
 Technology Integration
 Aesthetics
 Efficient Office Flow
 Cost Effective

NEXT STEPS

Now, go back through the designs we show on pages 6-21. Mark the features and looks that appeal to you. What do you like about one or all?

• Every Minute Counts Design

• Patient Focused Design

• Big Ideas Small Spaces Design

• Big Team Practice Design

A LITTLE MORE DETAIL

1. What type of dentistry do you practice?

- General Practice Specialty
 Oral Surgery Other

2. What type of room design concept do you prefer?

- Closed Room Open

3. If closed room, how many entries? One Two

4. What will be the depth of your future operatories?

(Ideal size is 10' W x 12' D x 9' H)

Op Depth: _____ Op Width: _____

Ceiling Height: _____

5. Where are clean instruments stored?

- Sterilization Area Operatories

6. Do you plan to use a cassette system?

- Yes No

7. What type of delivery do you prefer?

- Chair-mounted Rear Delivery Side Delivery

8. Where do you want your lighting mounted?

- Chair Cabinet Ceiling Track

9. Will there be monitors and CPUs in each operatory?

- Yes No

If so, what will they be used for? Practice Management

- Patient Education Entertainment

10. How many sinks? _____

Location(s)? _____

11. If imaging is in each operatory, where will it be mounted?

- Wall Central Cabinet Wall Pass-Through

12. Do you plan to have any hygiene specific rooms?

- Yes No

13. Are there any local codes/regulations we need to help accommodate? No Yes (please explain)

14. What types of ancillary equipment do you use in your operatories?

15. Any other specialty carts or equipment your operatory needs to accommodate?

MIDMARK CABINETS vs. LOCAL MILLWORK

Dental practices are specialized treatment facilities with needs that are profession and practice specific. Unlike Artizan® Expressions and Synthesis® Casework, local millwork is basic in design, and oftentimes, the builder lacks the expertise necessary to provide important functional features. Typical materials are not different than what is used in kitchen-grade cabinets; not durable enough to perform well in a dental environment. Understanding the difference in construction is very important.

BASE MATERIAL

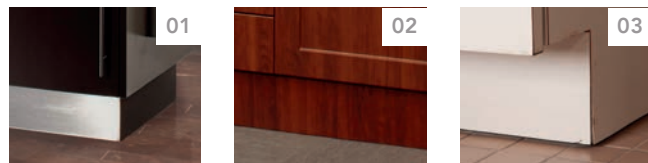

01| ARTIZAN EXPRESSIONS

- Seamless stainless steel
- Integrated adjustable levelers

02| SYNTHESIS CASEWORK

- Thermofoil over electrostatic, powder-coated painted steel (woodgrain and metallic colors)
- Electrostatic, powder-coated painted steel (solid colors)
- Integrated adjustable levelers

03| LOCAL MILLWORK

- Basic plywood or particle board covered with laminate
- Wood shims used for leveling

PANEL SUBSTRATES



01| ARTIZAN EXPRESSIONS

- Industrial-grade particle board
- 3/4" panels

02| SYNTHESIS CASEWORK

- Medium-density fiberboard
- 3/4" panels

03| LOCAL MILLWORK

- Low-density particle board
- Various types of plywood

CABINET FRAME

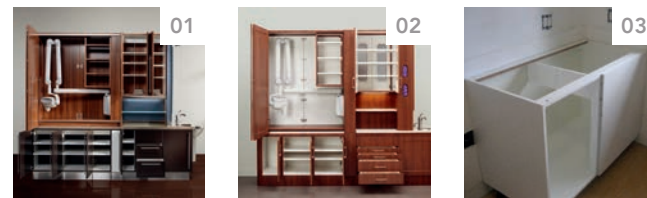

01| ARTIZAN EXPRESSIONS

- 3/4" industrial-grade particle board
- Can be configured to specific design requirements

02| SYNTHESIS CASEWORK

- 18-gauge cold rolled steel
- Modular design

03| LOCAL MILLWORK

- Often made from 1/2" to 5/8" low-density particle board or various types of plywood
- Basic or limited designs

FINISHES

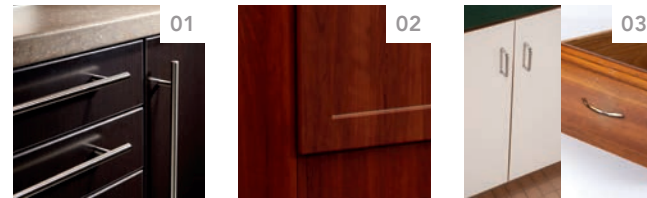

01| ARTIZAN EXPRESSIONS

- Factory pre-applied, thermally fused melamine

02| SYNTHESIS CASEWORK

- PVC thermofoil (woodgrain and metallic colors)
- PVC thermofoil and electrostatic, powder-coated paint (solid colors)

03| LOCAL MILLWORK

- High-pressure laminate
 - Do not always follow proper application methods
 - May use low grade substrate material
 - Inadequate edgebanding methods
- Varnished, painted or left unfinished

EDGE TREATMENTS

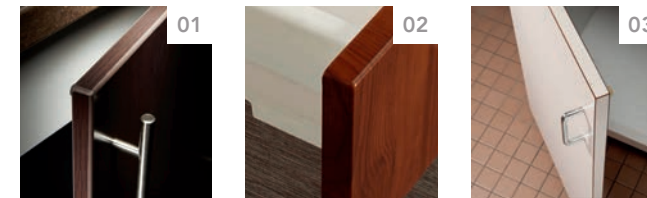

01| ARTIZAN EXPRESSIONS

- 3 mm PVC edgebanding

02| SYNTHESIS CASEWORK

- Membrane-pressed thermofoil

03| LOCAL MILLWORK

- Square edge strips
- 2 mm edgebanding

HINGES

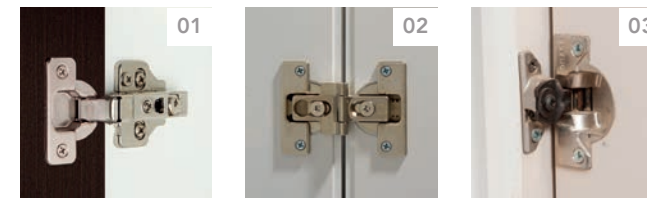

01| ARTIZAN EXPRESSIONS

- Quality, adjustable, concealed steel hinges
- Soft-close feature

02| SYNTHESIS CASEWORK

- Quality, adjustable, concealed steel hinges
- Secured to steel foundation

03| LOCAL MILLWORK

- Kitchen-grade hinges (less durable)

DRAWER SLIDES

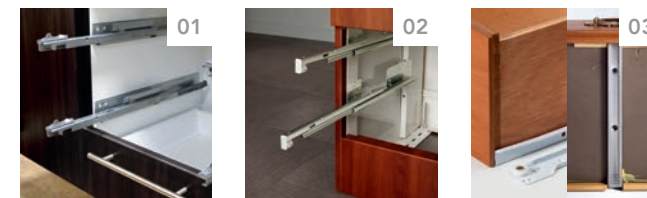

01| ARTIZAN EXPRESSIONS

- Full extension ball bearing drawer system
- Soft-close feature

02| SYNTHESIS CASEWORK

- Full extension ball bearing drawer system
- Secured to steel foundation

03| LOCAL MILLWORK

- Typically use a single, undermounted runner (monorail glide) or slides common in kitchens (less durable)

TYPES OF ASSEMBLY

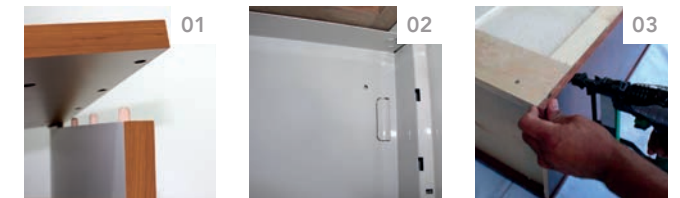

01| ARTIZAN EXPRESSIONS

- 100% glue dowel assembly

02| SYNTHESIS CASEWORK

- Mechanical fasteners (screws, pop rivets) and Tog-L-Loc® sheet metal joining system

03| LOCAL MILLWORK

- Frequently uses staple fasteners

DRAWERS

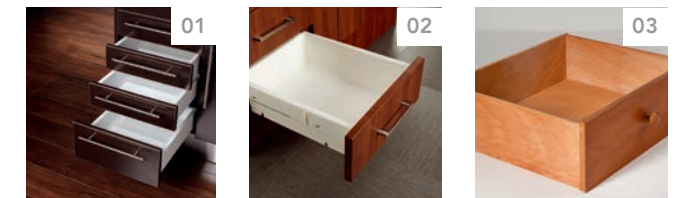

01| ARTIZAN EXPRESSIONS

- Wood bottom and backs with factory, pre-applied thermally fused melamine
- Metal sides with front panel adjustment and removal feature

02| SYNTHESIS CASEWORK

- Seamless, polystyrene drawers

03| LOCAL MILLWORK

- Inside drawers are often varnished, painted or left unfinished

HANDLES

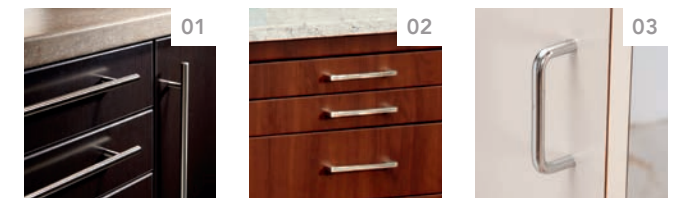

01| ARTIZAN EXPRESSIONS

- Brushed nickel handles

02| SYNTHESIS CASEWORK

- Integrated and insert handle option
- Brushed nickel pull options
- Antimicrobial option

03| LOCAL MILLWORK

- Most use "C" style pulls made of plastic or aluminum



UNDERSTANDING THE DETAILS

Both Artizan Expressions and Synthesis Casework provide designs that meet ergonomic workflow, infection control, technology integration and unique storage requirements, offering maximum flexibility to customize cabinetry solutions.

SYNTHESIS® CASEWORK

- Multiple Panel and Handle Styles
- Exceptional Durability
- Asepsis-Friendly Design
- Modular Design
- No Green Upcharge

ARTIZAN® EXPRESSIONS

- Modern Look
- Unique Design
- Design Flexibility
- Attention to Detail
- Specialty and Custom Offerings



*Artizan® Expressions Treatment Station protected by patents;
Synthesis® Casework patent pending manufacturing process*

SYNTHESIS STANDARD FEATURES

Aligned with the LEED® Green Building Rating System, Synthesis Casework's steel frame provides the durable structure and asepsis-friendly design required for long product life. Its internal and external modularity allows for easy modifications and component replacement as office needs evolve.

- 01| Touch Proximity Faucet
- 02| Tempered Glass in Optional Window Doors
- 03| Seamless Polystyrene Drawers and Seamless Panels
- 04| Concealed Steel Hinges
- 05| Full Extension Ball Bearing Glides
- 06| Solid Surface Countertops
- 07| Two Inch Drawer with Divider
- 08| Steel Frame Construction



SYNTHESIS COLOR AND STYLE OPTIONS

Synthesis® Casework offers different color and styling options to allow you to put your unique signature on a space, whether it is in one office or a multi-facility organization.

HANDLE STYLES



PANEL STYLES



*EPA Registration Numbers 84542-7 and 087753-CT-001
 **Available in Pebble Grey or Pebble Grey PVC Free only

CABINET FINISH

Membrane-pressed thermofoils seal the Synthesis MDF door and drawer panels. A special process is used to adhere the thermofoil to the steel structure on woodgrain and metallic colors. Solid colors have a matching painted structure. Thermofoil is a dimensionally flexible material that provides a continuous, seamless surface, eliminating the need for panel edgebanding while offering a high level of scratch and stain resistance.



The color swatches shown are the best representation of the original material. Actual color may vary slightly. In order to confirm your color selection, we strongly recommend that you contact Midmark Customer Experience at 1-800-MIDMARK to request a sample before placing your order.

COUNTERTOP COLORS

Solid Surface: DuPont® Corian® is a unique solid surface material. Since its creation, Corian® has proven itself to be a remarkably durable, versatile material that's an ideal surface for healthcare environments. **Quartz:** Dupont® Zodiaq® and LG Viatera® quartz is virtually maintenance free and, because quartz is one of nature's strongest materials, it is also incredibly durable, exceptionally tough and scratch resistant. **Laminate:** Offering a variety of Wilsonart® and Formica® selections, laminate countertops provide function while complementing any style of decor.

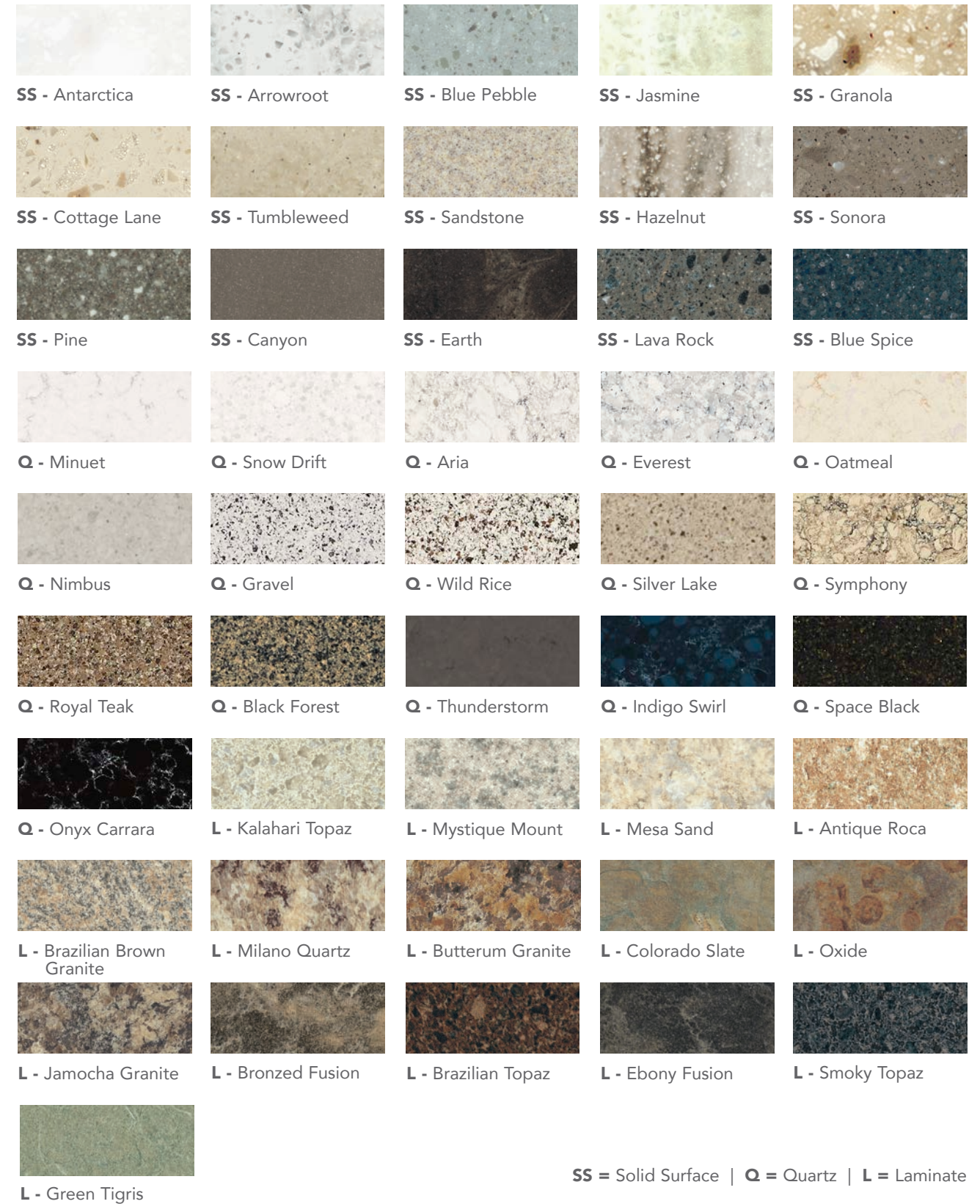

SS = Solid Surface | Q = Quartz | L = Laminate

ARTIZAN EXPRESSIONS STANDARD FEATURES

Artizan® Expressions brings a unique and modern look to the dental space. We believe "best is standard" and using only quality components and materials on every cabinet we build.

- 01| Stainless Steel Bases
- 02| Glue Dowel Construction
- 03| Cooling Fans for CPU Storage
- 04| Brushed Nickel Handles and 3mm Edgebanding
- 05| Concealed, Soft-Close Steel Hinges
- 06| Full Extension, Soft-Close Drawer Systems
- 07| Touch Proximity Faucet
- 08| Solid Surface Countertops



01

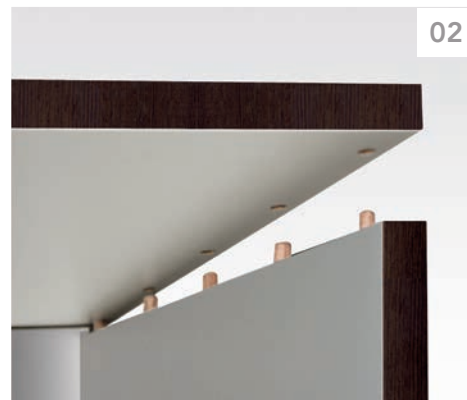

02



05

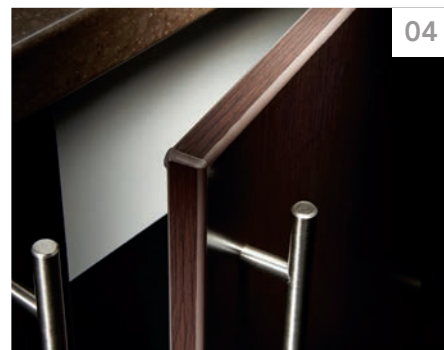

04



03



06



08



07

ARTIZAN EXPRESSIONS COLOR OPTIONS

Express who you are by combining rich and timeless elements from traditional to modern. Choose from a wide variety of plush upholstery, artful resin panels, woodgrain and solid cabinet panels, and durable countertop selections to create a style all your own.

RESIN

Lumicor® EcoShield panels are made of Lumiform, a PETG resin that is 40 times stronger than glass, impact resistant and contains a minimum of 40% recycled content. This resin fully encapsulates hand-laid botanicals, organics, woven textiles or graphics. The end result is a panel that provides an artful expression on your treatment station upper.

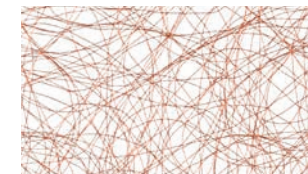

Copper Spun



Silver Spun



Mirage Bronze

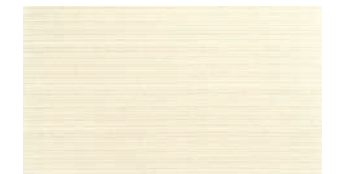

Ivory Taipei



Natura Ginger



Stone Linen



Araña Coco



Araña Pinto



Coastal Light

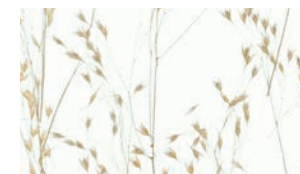

Meadow



Natural Leaves



Ginkgo



Ovalesque Print



White Interlock



Whitehaven



Kauri



Airlie



Nido

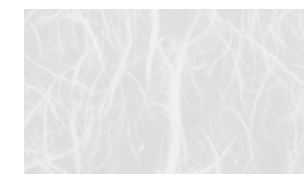

Chiroroot White

CABINET FINISH AND UPHOLSTERY COLORS

Cabinet Finish: Available in a variety of Arauco® and Formica® colors, Artizan® Expressions uses thermally fused melamine panels. These panels are created at high temperature and pressure to form a durable, peel-resistant finish. Matching edgbanding is applied to completely seal the corners from moisture. **Upholstery:** Accent your cabinetry with Ultraleather® which offers beautiful, luxurious, soft surfaces with exceptional durability.



CF = Cabinet Finish | U = Upholstery

COUNTERTOP COLORS

Solid Surface: DuPont® Corian® is a unique solid surface material. Since its creation, Corian® has proven itself to be a remarkably durable, versatile material that's an ideal surface for healthcare environments. **Quartz:** Dupont® Zodiaq® and LG Viatera® quartz is virtually maintenance free and, because quartz is one of nature's strongest materials, it is also incredibly durable, exceptionally tough and scratch resistant. **Laminate:** Offering a variety of Wilsonart® and Formica® selections, laminate countertops provide function while complementing any style of decor.

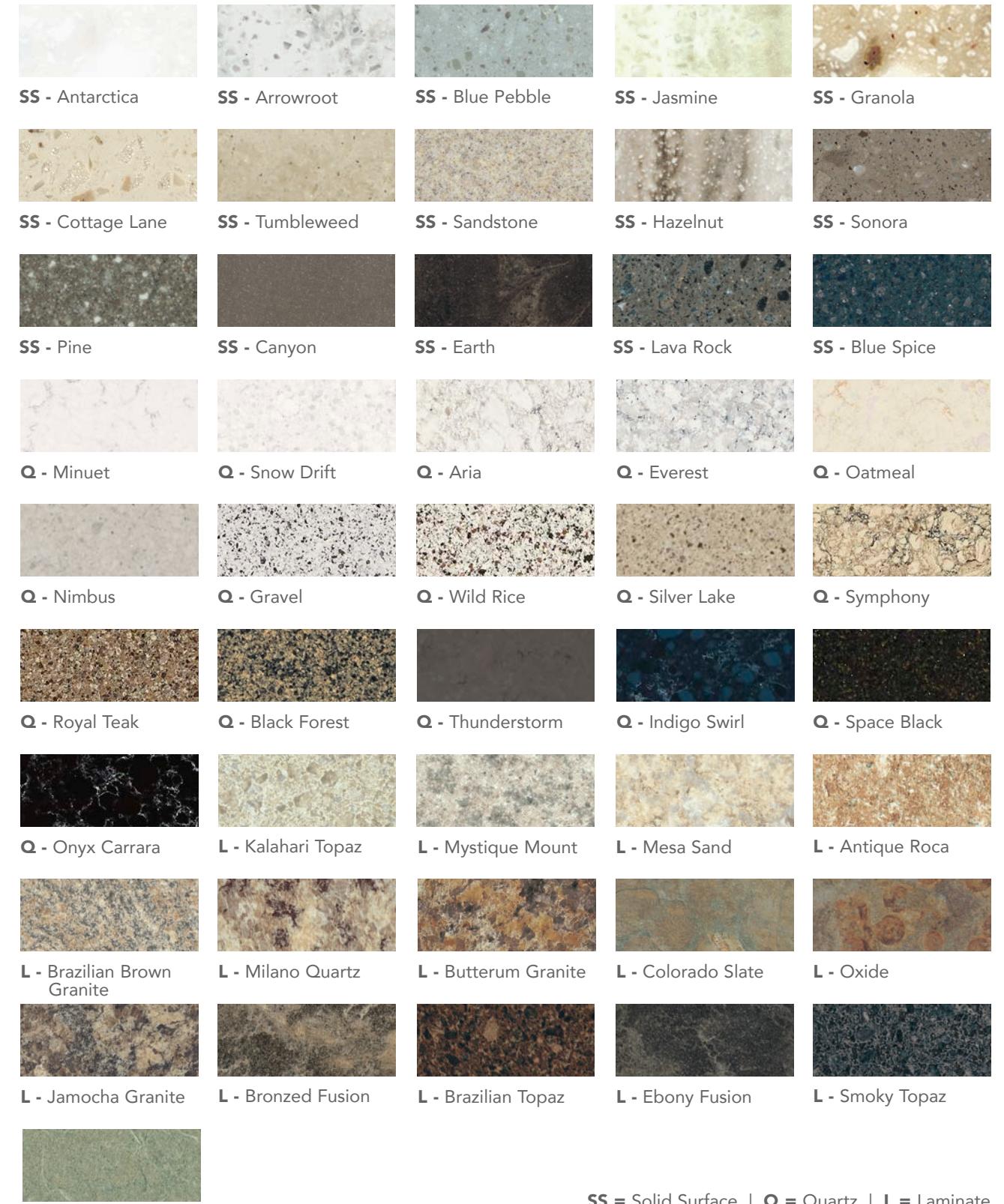

SS = Solid Surface | Q = Quartz | L = Laminate

DESIGN SUPPORT

WHAT YOU GET WITH MIDMARK

Durability. Craftsmanship. Precision.

When you choose Midmark, you get so much more than a product. You get a partner with decades of hands-on manufacturing expertise, inspired design innovation, and landmark thought leadership in workflow efficiency. A pioneer of cabinetry designed specifically for the healthcare market since 1967, Midmark continues its long tradition of improving patient care by infusing function-forward design, relentless quality and thoughtful technology into every product. And with an extensive warranty and dedicated technical support, we're right by your side the moment you need us.



Let Us Help Design Your Practice

Remodeling or building a new practice can be overwhelming. Midmark's in-house design experts can assist with your project. Using their deep knowledge of the dental workspace and keen eye for style, they will help create the right look and layout of your dream office.

One size does not fit all. With a variety of designs, sizes and styles available between both cabinet lines, we can help you create an attractive space that is functional and built to withstand the rigors of the dental environment. Go with all one line, or mix and match our two lines to meet your needs now and into the future.

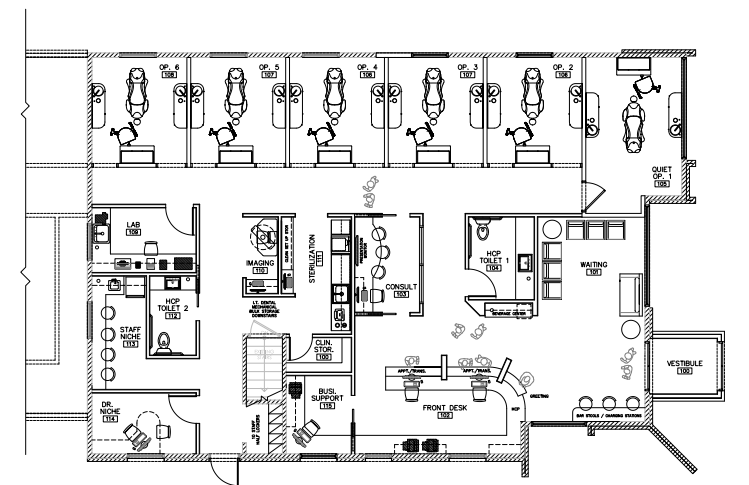

SEE WHAT OUR CUSTOMERS ARE SAYING

"I really like how modern the Artizan Expressions look can be. It allows a lot of versatility to customize a space to your own style."

Dr. Jenna Triggiani
Two Rivers Family Dentistry, Lisbon, ME

"During my search for dental cabinetry, I wanted a product that was made in America but still very durable. The Synthesis Casework Collection offered both, and also had beautiful wood grains to choose from. We've had our cabinetry for five years and it still looks brand new. I fully believe that this cabinetry can last 30 plus years."

Dr. Ron Holiman
Plaistow Dental, Plaistow, NH

"Strong yet stylish, the steel Midmark casework line was the right choice for my new office. With well thought out functionality in a contemporary design, it shows every patient that our office invests in the absolute best for their care."

Dr. Brian S. Nylaan
Brian S. Nylaan, D.D.S. - General and Cosmetic Dentistry, Grand Rapids, MI

"The unique design of the Artizan Expressions cabinetry line sets my office apart from other traditional dental cabinetry. Midmark has also done a great job with the ergonomic storage and overall function of the cabinetry, they've thought of it all!"

Dr. Reza Nazari
Granada Dental, Livermore, CA

"The Midmark Artizan Expressions cabinetry line offers a modern and non-traditional cabinetry style. All other competitor cabinetry was very boxy and dated; my office has a modern design and the cabinetry fits perfectly."

Dr. Maryam Horiyat
Aria Dental, Mission Viejo, CA

"It has almost been ten years since we had our Synthesis cabinets from Midmark installed, and they still look and perform just as well as when they were first installed! We loved being able to go to the Midmark showroom and see all of their products in work settings. It clearly demonstrated to us our options and allowed us to see and choose exactly which products would best suit our needs. We wouldn't go anywhere else."

Dr. Mark Armstrong
Armstrong Dentistry, Troy, OH



WARRANTY & SERVICE

We stand by the quality and reliability of our Artizan® Expressions and Synthesis® Casework lines - that is why we offer a standard five year limited warranty for both lines purchased through an authorized Midmark dealer. In addition to warranty, Midmark has a large team of expert customer experience and technical support representatives that will assist you with any product questions regarding installation and service.

MANUFACTURING

Using the knowledge accrued during our more than 100 years of manufacturing history, Midmark continues to invest in its production systems. To support a growing casework business, the Synthesis manufacturing space in Ohio has been expanded by over 50,000 square feet.

Significant investments in state-of-the-art machinery have been made at our Ohio facility as well as Kentucky facility, where the Artizan Expressions line is manufactured. All of this to bring you the highest quality and performance you expect from your dental cabinetry.



Synthesis steel frame panel being made to exact specification on the state-of-the-art bending machine



Solid surface tops are manufactured by our fabrication experts at our Artizan Expressions facility

RESOURCES

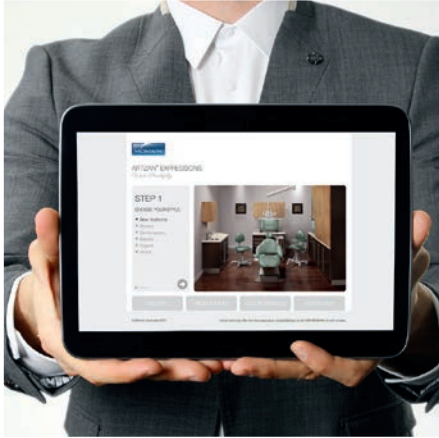

DENTAL DESIGN TOOL

Our easy-to-use, life-like digital tool helps you find your individual style and visualize what your operatory and sterilization space will look like.



DENTAL DESIGN TOOL
[apps.midmark.com/
dental-design-tool](http://apps.midmark.com/dental-design-tool)



HOW IT'S CREATED

If you can't come to us, we'll come to you. Check out our videos on how both Artizan® Expressions and Synthesis® Casework are made. See the quality and craftsmanship that go into each and every cabinet we produce.



THE CREATION OF ARTIZAN® EXPRESSIONS
midmark.com/artizanexpressions_creation



THE CREATION OF SYNTHESIS® CASEWORK
midmark.com/synthesiscasework_creation



For more information, visit midmark.com/midmarkcabinetry

Ask About Our Complete Line of Specialized Cabinetry for Your Sterilization Center.

The color swatches shown are the best representation of the original material. Actual color may vary slightly. In order to confirm your color selection, we strongly recommend that you contact Midmark Customer Experience at 1-800-MIDMARK to request a sample before placing your order.

CARB 93120.2 Phase 2 Compliant

Midmark is an ISO 13485 and ISO 9001 Certified Company. For more information or a demonstration, contact your Midmark dealer or call: 1-800-MIDMARK Fax: 1-877-725-6495 Outside the U.S.A. call: 1-937-526-3662 Fax: 1-937-526-8214 or visit our website at midmark.com

© 2017 Midmark Corporation, Dayton, OH.
Products subject to improvement changes without notice
Litho in U.S.A. 007-10010-00 Rev. A1 (6/17)



Because we care.